



Fascia Bracket & Post Installation Guide

Step 1: Determine post position based on overall deck dimensions.

Note 1: Distance between railing posts should never exceed 6ft.

Note 2: When using fascia mounted railings on deck, it is recommended that you use fascia mounted rail on stairs. Install stair posts first to determine position of first deck post.

Step 2: After determining post position install fascia bracket onto fascia board 3" down from top of deck using 6- 5/16" x 5" hex head coated lag screws or bolts with 1 3/4" collar. (sold separately)

Note: Edge of deck must have minimum 3/4" to a maximum of 2" nosing installed (see below). The same procedures are used for end, line 90°, or 45° and custom fascia brackets.

Step 3: Slide post into fascia bracket, plumb and secure with 6 - #10 x 3/4" tek screws. (sold separately)

Note: The same procedures are to be used for Century picket, glass and Scenic Series 10mm glass systems.

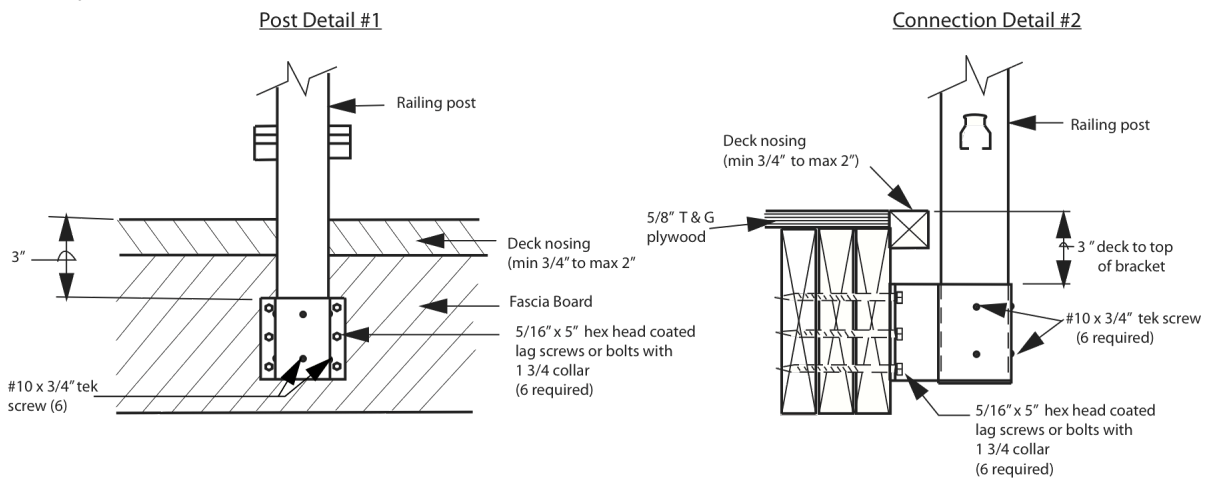

Fascia Mount Support Leg Installation Instructions

Step 1: After the railing is installed determine location of support leg to be installed. (support legs sold separately) Evenly space support legs in railing section as indicated below.

- For 4' sections, 2 support legs are required evenly spaced between posts.
- For 6' sections, 3 support legs are required evenly spaced between posts.

Note: Distance between support leg and posts or second support leg should never exceed 18" (see placement detail #3)

Step 2: After determining support leg position fasten to fascia board using 2 - #12 x 2" screws (supplied).

Note: Bottom rail should be resting on support bracket. Distance between bottom of support leg bracket and top edge of deck should be 3 - 1/2" (see connection detail below #4)

Step 3: Fasten support leg to bottom rail using 1 - #10 x 3/4" tek screw. (see connection detail #4)

